

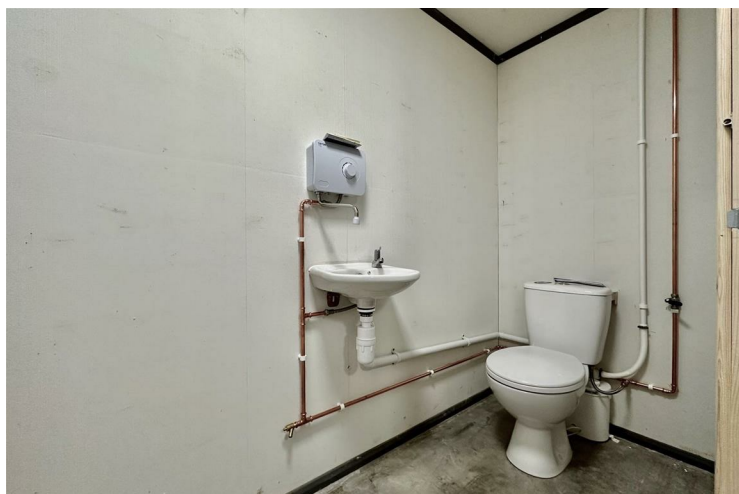

**SPURWAY DAYS-POTTLES LANE  
EXETER  
EX6 8AZ**

**£650 Per month**

Lock-up storage/workshop unit  
Lighting and power  
Own WC  
Parking  
Available now  
Suitable for various uses.



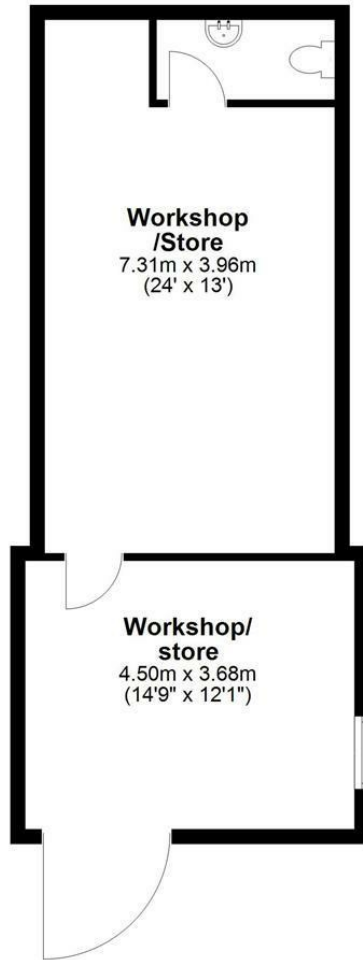

Total area: approx. 46.0 sq. metres  
(494.6 sq. feet)

**Unit 4 Spurway Farm, Exminster**



Energy Efficiency Rating		Current	Potential
Very energy efficient - lower running costs			
(92 plus) <b>A</b>			
(81-91) <b>B</b>			
(69-80) <b>C</b>			
(55-68) <b>D</b>			
(39-54) <b>E</b>		42	
(21-38) <b>F</b>			
(1-20) <b>G</b>			
Not energy efficient - higher running costs			
<b>England &amp; Wales</b>		EU Directive 2002/91/EC	

Agents Note: Whilst every care has been taken to prepare these particulars, they are for guidance purposes only. All measurements are approximate and are for general guidance purposes only and whilst every care has been taken to ensure their accuracy, they should not be relied upon and potential buyers/tenants are advised to recheck the measurements

